

BRINN TRANSMISSION AND PARTS

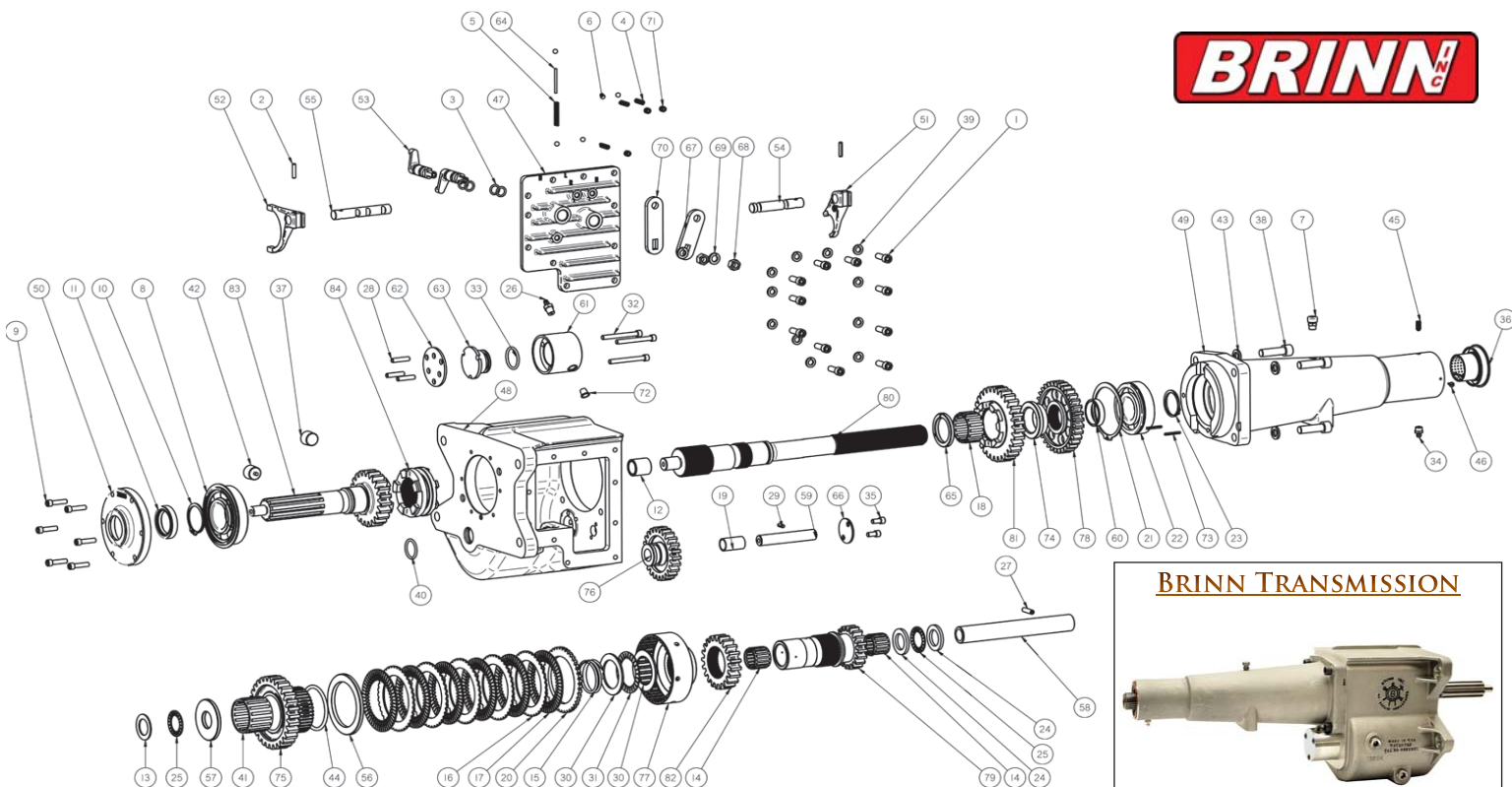

Item	Part Number	Description	Price
1	136-71001	5/16-18 x 7/8" SHCS	1.09
2	136-71002	Roll Pin	0.39
3	136-71003	O-Ring 10.5mm x 3.0	1.29
4	136-71004	Detent Spring	4.89
5	136-71005	Lockout Spring	7.69
6	136-71006	Lockout Detent Ball	0.59
7	136-71007	Vent Assembly	4.89
8	136-71008	Bearing	24.79
9	136-71009	1/4-20 x 1" SHCS	0.99
10	136-71010	Retaining Ring	1.89
11	136-71011	Oil Seal	8.79
12	136-71012	Machined Bushing	13.69
13	136-71013	Thrust Washer (.060" Thick)	5.69
14	136-71015	Bearing	8.49
15	136-71016	Clutch Release Spring	11.49
16	136-71017	Steel Clutch Pressure Disc	7.19
17	136-71018	Metallic Friction Disc	31.89
18	136-71019	Cage Bearing	18.99
19	136-71020	Bushing	7.19
20	136-71021	Rear Clutch Disc (.183" Thick)	28.29
21	136-71022	Retaining Ring	17.99
22	136-71023	Bearing	23.79
23	136-71024	Retaining Ring	3.89
24	136-71025	Thrust Washer (.154" Thick)	12.89
25	136-71026	Needle Thrust Bearing	6.29
26	136-71027	Bleeder Assembly	11.29
27	136-71029	Roll Pin	0.59
28	136-71030	Clutch Actuator Pin	7.69
29	136-71031	Roll Pin	0.29

Item	Part Number	Description	Price
30	136-71032	Thrust Washer (.095 Thick)	16.79
31	136-71033	Needle Thrust Bearing	12.29
32	136-71034	1/4-20 x 2 1/4" SHCS	1.69
33	136-71035	Clutch Piston O-Ring	5.09
34	136-71037	Grease Fitting 1/8 NPT	2.19
35	136-71038	1/4-20 x 1/2" SHCS	0.39
36	136-71040	Bushing & Seal	15.69
37	136-71041	Fill Plug	2.09
38	136-71042	7/16-14 x 1 1/2" SHCS	3.19
39	136-71043	5/16 Lock Washer	0.19
40	136-71046	O-Ring	1.29
41	136-71049	Cage Bearing	30.99
42	136-71059	Magnetic Drain Plug	7.99
43	136-71061	7/16 Lock Washer	0.19
44	136-71063	O-Ring 70 Durometer Nitrile	1.29
45	136-71064	Brass Tip Dog Point Set Screw	4.99
46	136-71065	Set Screw	0.39
47	136-72001	Side Cover, Bare for 70001	143.99
48	136-72002	Main Case, Bare for 70001	315.99
49	136-72003	Output Housing for 70001	219.99
50	136-72004	Front Retainer	22.79
51	136-73001	Reverse Shift Fork	32.49
52	136-73002	High/Low Shift Fork	31.49
53	136-73003	Shift Lever	30.29
54	136-73005	Reverse Shift Rod	20.39
55	136-73006	High/Low Shift Rod	23.29
56	136-73007	Forward Clutch Ring	21.49
57	136-73009	Thrust Race, Intermediate shaft	23.54
58	136-73010	Guide Pin	40.99

Item	Part Number	Description	Price
59	136-73011	Reverse Idler Shaft	24.99
60	136-73012	Output Shaft Bearing Spacer	21.99
61	136-73013	Piston Cap	36.49
62	136-73014	Intermediate Shaft Retainer	6.59
63	136-73015	Clutch Actuator Piston	23.99
64	136-73016	Detent Lockout Pin	2.79
65	136-73017	First Gear Spacer	26.99
66	136-73020	Reverse Idler Shaft Cover	7.09
67	136-73021	Reverse Lever	16.59
68	136-73022	3/8-24 Nut	0.49
69	136-73023	3/8 Lock Washer	0.14
70	136-73024	High/Low Shift Lever	17.99
71	136-73025	5/16-18 Set Screw	3.14
72	136-73026	Plug	0.29
73	136-73029	1/8 X 1 Roll Pin	0.29
74	136-73031	Low/Reverse Spacer	27.99
75	136-74002	Input Mesh Gear Driven	164.99
76	136-74004	Reverse Idler Gear	103.99
77	136-74006	Clutch Housing	121.99
78	136-74007	Reverse Gear Driven	94.99
79	136-74008	Intermediate Shaft	175.99
80	136-74010	Output Shaft	364.99
81	136-74011	First Gear Driven	152.99
82	136-74012	First Gear Driving	54.99
83	136-74020	Input Shaft	339.99
84	136-74021	High/Low Dog Ring	125.99

Driveline • Clutches • Bell Housing • Transmission • Drive Shaft • Rear End • Driveline • Clutches • Bell Housing • Transmission • Drive Shaft • Rear End • Driveline • Clutches • Bell Housing • Transmission • Drive Shaft • Rear End